



SABAR ENGINEERING PVT. LTD., G.I.D.C. PHASE-IV, VATVA, AHMEDABAD- 382445

WORKS PH.NO.: 25840415, 25840100

MARKETING PH.NO.: 25840213, 25840261 FAX : 25840289



SPECIAL INDUCTION MOTOR DEVELOPMENT REQUEST

INFORMATION TO BE GIVEN AT THE STAGE OF ENQUIRY / PLACING ORDER | DATE :

MOTOR RATING DETAILS :

HP/KW : _____ VOLTS : _____ \pm _____ % , Hz _____ \pm _____ % No. of Phases : _____
 Insulation Class : _____ Degree of Protection(IP 44, IP 55, IP 56) : _____ Connection : _____
 Duty (S1 to S9) : _____ Rated Speed : _____ Rated Current : _____

GENERAL DETAILS :

Construction & Mountings : _____
 Site & Operation Condition : _____
 Any Special Shaft Extension/Shaft End Tapping : _____
 Special Key / Key Way Size : _____
 Direction of Rotation : _____ The Alitude (if >1000 MSL) : _____ Mtr.
 Terminal Box Position : _____ Ambient Temp. : _____
 Any Special Earthing System : _____ No. of Terminal Out put : _____
 Method of Cooling : _____ Reference of Standard : _____
 Application : _____ Driven Equipment : _____

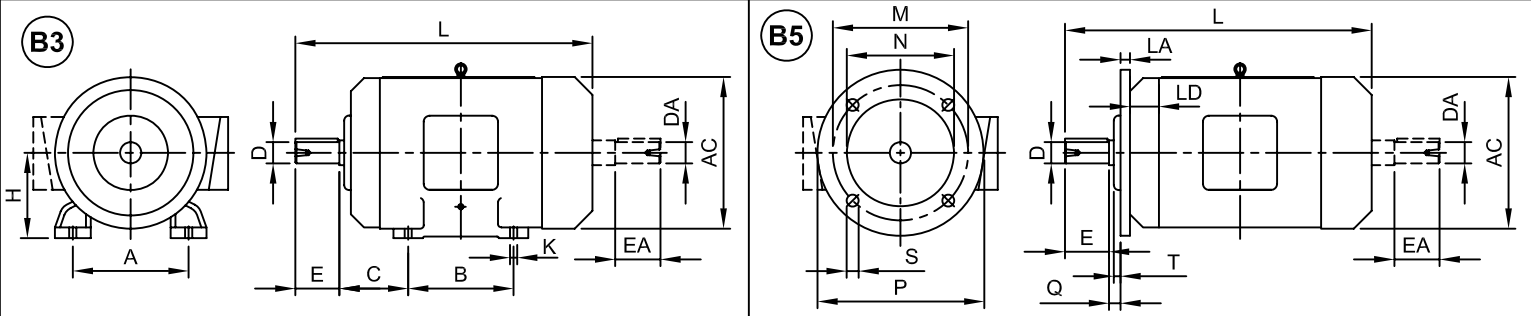

Customer Specific Requirement Besides The Standards as per Catalogue

Frame	A	B	C	D	E	H	K	EA	DA	AC	L	M	N	S	P	Q	T	LA	LD			

CUSTOMER COMMENTS :

COMPANY DETAIL:

PREPARED BY:

NAME / DESIGNATION / SIGN

SPECIFIC DETAILS :

Method of Starting : _____ Starting Torque : _____

Period of Acceleration : _____

Speed Torque Diagram of the Driven Equipment : _____ Attach Separated Sheet

For Enquiry of Hoist or Carne Duty Motor Please submit following details :

Type (TE or TEFC) : _____

Duty Cycle factor (25%, 40%, 50%, 60%) : _____

Duty Cycle / Sequence of Operation(S2 /S3/ S4 /S5) : _____ Vibration Level : _____

GD² & Relevant Speed of Driven Equipment : _____

Method of Breaking (Mechanical / Electrical) : _____

No. of Start / Stop per hr. : _____ No. of Reversal / hr. : _____

ANY SPECIAL REQUIREMENT :

Like Thermister, P.T., Colour Packing, Delivery, Special Grease, Inverter duty type Frequency Drive, Encoder, Special Cooling for Motor or Others.

SIGN :

MARKETING PERSON COMMENTS:

SIGN :

MANUFACTURING SIDE COMMENTS:

SIGN :